



## IN LINE ELECTROLYTIC SCALE INHIBITOR

### KEY FEATURES

- One year replacement guarantee
- WRAS approved product
- Maximum working pressure: 10 bar
- Service life - up to 10 years
- Saves on energy costs
- Easily installed
- No moving parts
- No maintenance required
- No power or replacement parts needed



Product Code	Description	Fitting Type	Overall Length	Overall Diameter
BFMBSRCE-15	Electrolytic scale reducer 15mm	Compression	181mm	32mm
BFMBSRCE-22	Electrolytic scale reducer 22mm	Compression	186mm	32mm
BFMBSRPFE-15	Electrolytic scale reducer 15mm	Push-fit	188mm	32mm

from  
**NAVIGATOR®**

t: +44 (0)1234 781234 | e: [sales@navigatormsl.com](mailto:sales@navigatormsl.com)  
[www.navigatormsl.com](http://www.navigatormsl.com)

# WHY FIT AN ELECTROLYTIC SCALE INHIBITOR?



Most areas in the UK have calcium carbonate present in the water supply. High concentrations are known as “hard water areas”. Where this water is present in a heating system, or is left standing for a long period, mineral deposits will crystallise to form limescale.

Scale adheres to pipe and other parts in the system, causing a drop in performance and ultimately damage and failure to expensive components such as boiler heat exchangers and central heating systems.

Scale reduces the life of your boiler and restricts the flow of water at the nozzles, which increases boiler noise.

Our Magblu Electrolytic Inhibitors are WRAS approved and work for whole house applications and high-volume intermittent appliances such as showers. They add a small trace of zinc to the water which bonds with calcium ions, making it more difficult for precipitation to occur.

For your convenience choose from either a push fit or compression style to suit your needs.

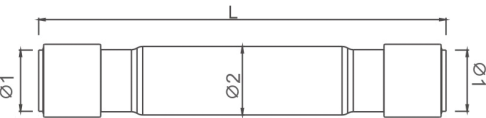

Product Number	L mm	Ø1 mm	Ø2 mm
BFMBSRPFE-15	188	15	32

bar	0.5	1	1.5	2	2.5	3	3.5	4	4.5	5
Ø15 L/min	21	25	30	35	38	41	45	48	52	56

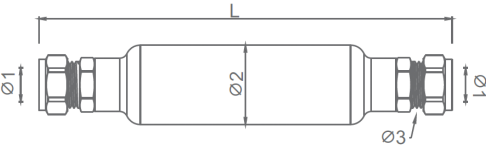

Product Number	L mm	Ø1 mm	Ø2 mm	Ø3
BFMBSRCE-15	181	15	32	G1/2"
BFMBSRCE-22	186	22	32	W1½"

bar	0.5	1	1.5	2	2.5	3	3.5	4	4.5	5
Ø15 L/min	13.3	16.8	19.7	20	24.5	26.2	28	29.8	31.5	33
Ø22 L/min	16	20	23.3	26	28.7	31.5	33.6	35.8	38	40

## Product Parameter:

	<b>P</b>	<b>bar</b>		<b>Test pressure</b> 16bar		<b>Static pressure</b> min.0.5-max.10		<b>Flow pressure</b> 1-5bar		<b>Flow pressure</b> 3bar	
	<b>T</b>	<b>°C</b>		max. 30°C/4min Thermal disinfection		max. 45°C min. 5°C		max. 45°C min. 25°C		max. 30°C	

