



Description

- Suitable for hot and cold water, heating and chilled water systems.
- Designed for confined spaces and/or where the use of heat must be avoided.
- Available in brass.
- Also available in nickel plated.
- Compatible with pert pipe or pert-al-pert pipe.
- Fast and easy to use flame-free installation.

Product code	Description	Pack Quantity
ZL-1039/10/1.3	10mm x 1.3mm Eurocones	1 x Pair
ZL-1039/12	12mm Eurocones Inner 8mm Outer 12mm	1 x Pair
ZL-1039/12/1.6	12mm Eurocones Inner 8.8mm Outer 12mm	1 x Pair
ZL-1039/15	15mm Eurocone Inner 11mm Outer 15mm	1 x Pair
ZL-1039/16	EUROCONES INNER 12MM OUTER 16MM (2mm)	1 x Pair
ZL-1039/16/1.5	16mm*1.5mm Eurocone Connector	1 x Pair
ZL-1039/17	17mm Eurocone Inner 13mm Outer 17mm	1 x Pair
ZL-1039/20	20mm Eurocone Inner 16mm Outer 20mm	1 x Pair

Technical Data

Applications & Technical Information	
Sanitary water	Y
Heating and chilled water systems	Y
glycol	Y
Available sizes: water	10 - 20 mm
Available sizes: glycol	10 - 20 mm
Warranty	Backed by full manufacturers product warranty
Operating parameters: water	16 bar at 95°C
Operating parameters: glycol	16 bar at 95°C
Material	Brass

Dimension

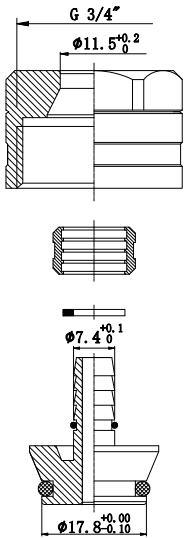

ZL-1039/10/1.3

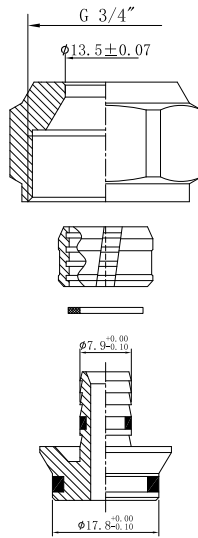

ZL-1039/12

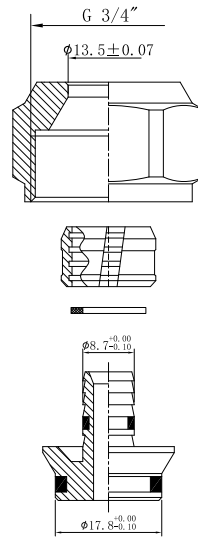

ZL-1039/12/1.6

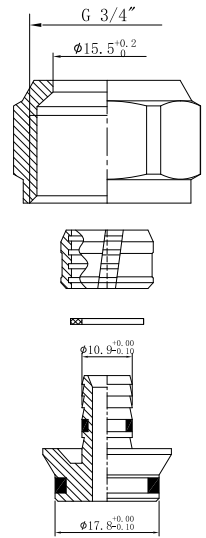

ZL-1039/12/15

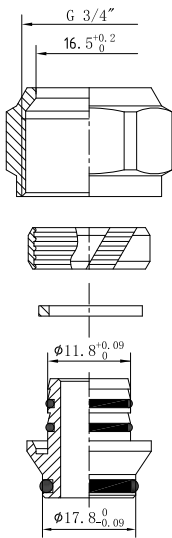

ZL-1039/16

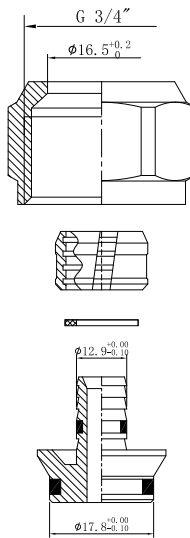

ZL-1039/16/1.5

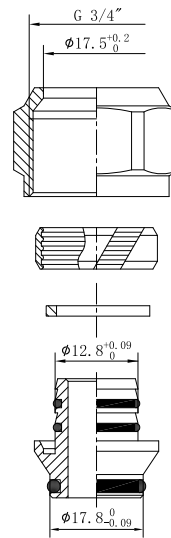

ZL-1039/17

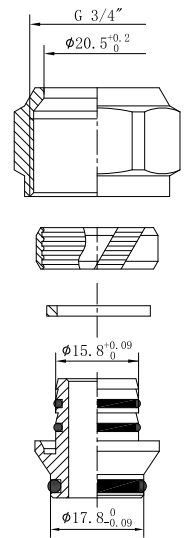

ZL-1039/20